

Since the usage and finishing of the product is not under our control, we accept no liability for the success of our products as per the accompanying product data sheets and in accordance with our general terms and conditions of sale. The properties listed here represent no guarantee with respect to the eventual use of our products. We reserve the right to make changes due to technical advances. Any other technical information given in the course of a consultation must be confirmed in writing. Colours shown here are restricted by the printing techniques and may differ from those exhibited by the products themselves. We also reserve the right to make alterations to the product technology or design. Only the current version of this data sheet is valid. Such versions are accessible by anyone via the internet. The issue of the latest data sheet invalidates all those that have been published beforehand.

# DURABASE CI++

1/2

Installation  
Instructions

## Decoupling mats for indoors and outdoors

**DURAL**

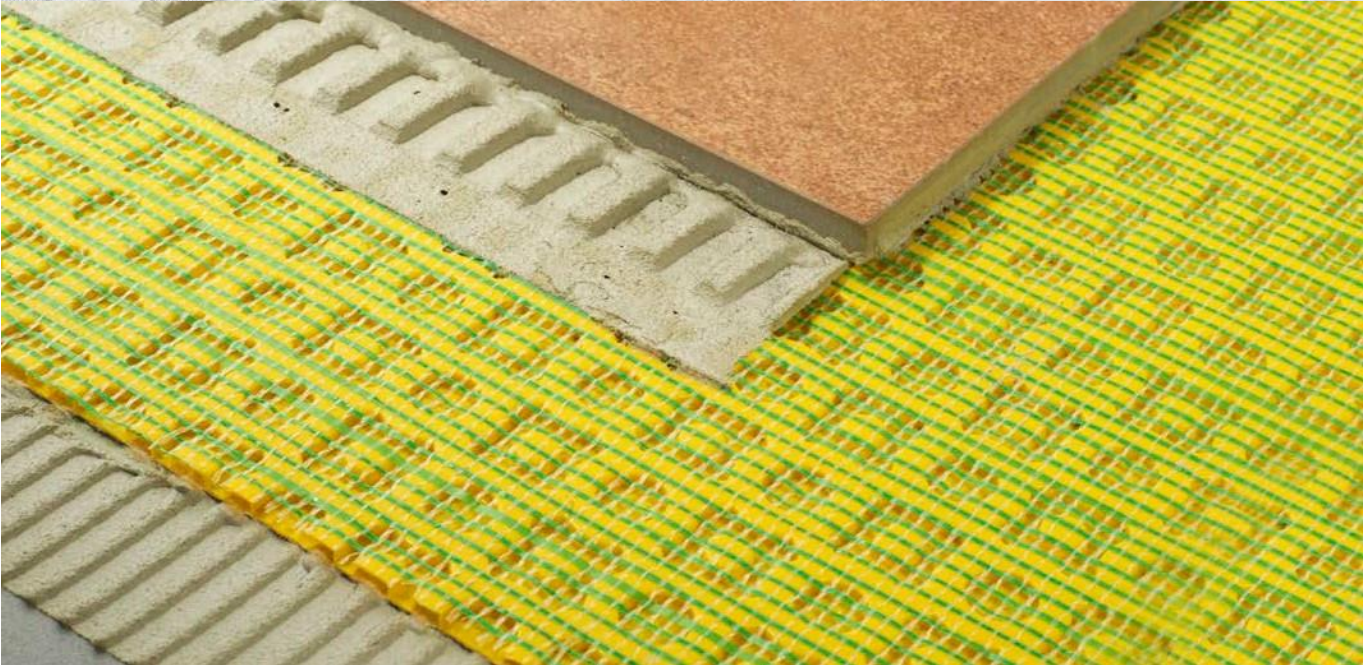

### INSTALLATION INSTRUCTIONS:

The floor making up the foundation must be free of any material that would impair adhesion. It must be level and able to bear weight. Any evening out to be done must be completed before DURABASE CI++ is laid. The adhesive is chosen depending on the nature of the foundation. The adhesive must bond to the foundation and to the backing fleece of the DURABASE CI++ mats.

For most surfaces a water-based thin-bed mortar (C2 quality) can be used. The mortar is applied to the foundation using a serrated trowel (4 x 4 mm).

Important: Do not use a wider serrated trowel, since the decoupling effect of the mat can be impaired. Important: do not use larger sized serrated trowels or the decoupling effect of the CI++ matting will be impaired. This in turn will create a crunching sound under foot.

Having been cut to size, the rolls must quickly be laid over the entire surface with the fleece backing on the adhesive. The rolls can be pushed into place using a roller or other suitable tool. Make sure this is done before the adhesive is dry. To avoid damage to the rolls

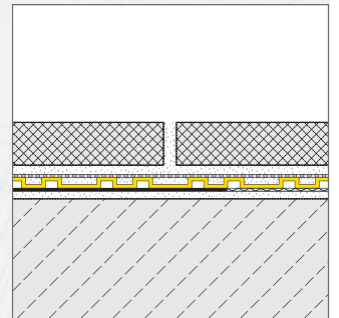

**STONE CONCEPT HOLDINGS P/L**  
3/179-183 Woodpark Road,  
Smithfield, NSW, 2164  
Tel. +61 (02) 9757 3880  
Fax +61 (02) 9818 5073  
products@stoneconcept.com.au

# DURABASE CI++

2/2

Installation  
Instructions

**DURAL**

## Decoupling mats for indoors and outdoors



being laid, it is recommended that they be protected from loading by laying boards on them. Other protective measures may be necessary, too, e.g. protection from direct sunlight or rain in outdoor locations. Any water collecting in the texturing must be removed before applying thin-bed mortar.

Always cover over junctions between mats with DURABASE WP or DURABASE WPFB tape. Pre-shaped parts shall be used. For inside and outside-facing corners.

As soon as the DURABASE CI++ matting has been laid, tiles can be laid on top of it using a thin-bed technique and a thin-bed mortar appropriate to the flooring. Practically, it is advisable to apply mortar to the round depressions in one working step and then apply thin-bed mortar and roughen it in another. The work can also be done in such a way that the application of the top mortar layer only starts after the initial application has hardened.



The tiles must be embedded in the mortar to cover the entire surface. The depth of the serrations on the trowel must be appropriate to the tile format. Make sure this is all done before the adhesive is dry. For flooring out of doors, the laying of tiles should only begin after the mortar for the CI++ underlay has properly hardened.

Where expansion joints are used to delineate areas, edges and junctions, professional regulations should be observed. Flooring outdoors, large size tiles or any flooring subject to heavy loading should be laid using a combined installation procedure.

Note: For balcony or patio coverings expansion joint profiles with spacing 2.50 m up to 5.00 m max in delineated areas should be installed observing professional regulations. In this context the CI++ matting must feature an expansion joint too. This joint must be waterproof covered with a WP sealing tape installed as a loop.

Thin tiles (so called slim tiles) are not allowed for use.

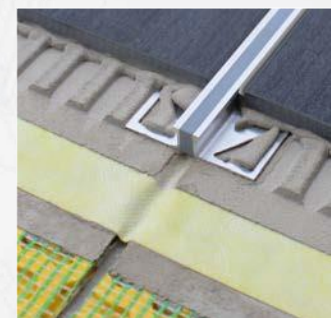

**STONE CONCEPT HOLDINGS P/L**

3/179-183 Woodpark Road,

Smithfield, NSW, 2164

Tel. +61 (02) 9757 3880

Fax +61 (02) 9818 5073

products@stoneconcept.com.au