

Metal Profile Expansion joint with EPDM

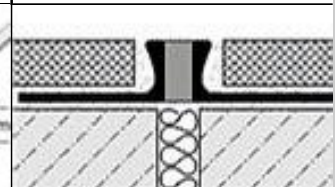
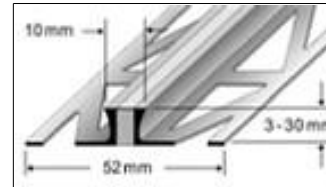

Application:

DURAFLEX metal profiles by Dural are made for particularly highly stressed floors. For example, the expansion joint profiles are suited for warehouses and production floors, underground garages and shopping centres as well as any floors that are to be cleaned using machines. The visible surface of the profile is 10 mm. Both legs are equipped with an EPDM expansion zone.

The specially developed expansion joint profile absorbs heavy stresses and spreads them evenly throughout the flooring and the foundations. It also prevents transmission of footfall and sounds from other objects. Important: any expansion joints in the foundations need to be followed precisely.

Material:

DURAFLEX expansion joint profiles using DUROSOL metal profiles are available in three versions: aluminium, brass and stainless steel. Other materials are available on request.

Properties:

DURAFLEX **aluminium** profiles may be used wherever unusual chemical reactions are not to be expected. To avoid corrosion, it is necessary to take care with cement materials. Since aluminium is susceptible to alkalis, any mortar, tile adhesive or grout residues must be removed immediately from all visible surfaces. The profile must be completely embedded in the contact layer. This avoids the formation of pockets where alkaline solutions of water can collect.

DURAFLEX **brass** profiles can also be used in industrial concerns. They can withstand heavy loads and are largely resistant to the chemicals used for laying tiles.

Important: brass oxidises in air, especially in humid conditions. The surface then develops a patina and its appearance is thus altered.

DURAFLEX **stainless steel** profiles are particularly suitable for areas that are subject to large amounts of chemicals and acids. Since they are also able to withstand the utmost mechanical demands, stainless steel profiles are used in the food industry, in hospitals, swimming pools and breweries.

The EPDM expansion zones are resistant against all the chemicals to which tiles are usually subjected.

The usage of any materials with regard to chemical and mechanical resistance should be assessed in each individual case.

Installation:

1. DURAFLEX expansion joint profiles should be chosen to match the thickness of the tiles
2. Tile adhesive should be applied around the junction using a serrated trowel.
3. Press the DURAFLEX profile into the adhesive bed and align it. Follow any existing joints in the foundations.
4. Spread mortar over the entire surface of the joint.
5. Press in tiles firmly and align them so that they are flush with the top edge of the profile. Lay the tiles without leaving any gaps.
6. Allow a joint of 2 mm around the profile itself.
7. Then fill the space between the tiles and the profile with grout.

Maintenance:

DURAFLEX profiles do not require any special maintenance. They are resistant to bacteria and fungus and are “automatically” cleaned when the tiles are cleaned. Cleaning agents should be free of hydrochloric and hydrofluoric acid and should not contain abrasives.

Data sheet

Material	Inserts (grey)	Height
Aluminium / Brass / Stainless steel	EPDM	3 – 30 mm